

New Door Preparation

Model No. PAKL-01

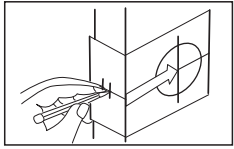

1. MARK DOOR

Select 2-3/8" (60mm) or 2-3/4" (70mm) backset as desired and mark center of hole on door face.

USE ENCLOSED TEMPLATE

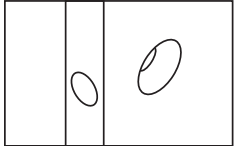

2. DRILL HOLES

A. Bore 2 1/8" (54mm) hole through door face from both side of the door to avoid damaging door surface.

B. Drill 1" (25mm) hole through door edge.

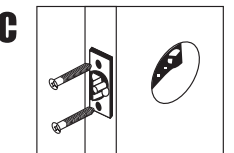
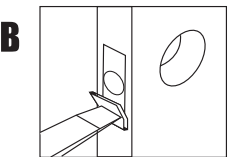
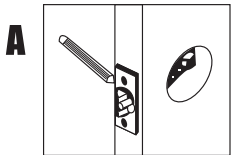

3. INSTALL LATCH

A. Insert latch in hole and keep it parallel to door face. Mark outline of face plate and remove latch .

B. Chisel 1/8" (3mm) deep or until face plate is flush with door edge.

C. Insert latch and tighten screws.

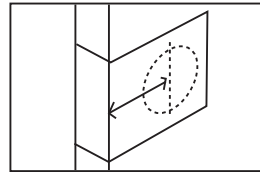

5. VERIFY BACKSET

Backset is the distance from door edge to center of hole on door face.

All locks are supplied with adjustable latch which can fit 2-3/8" (60mm) or 2-3/4" (70mm) backset.

Just follow the steps shown below to change backset.

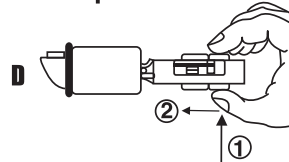
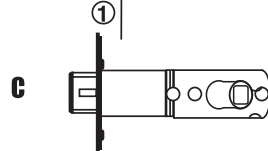
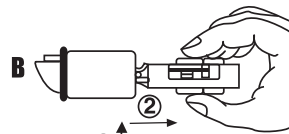
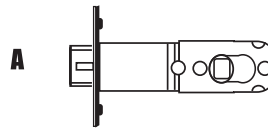

6. ADJUSTING BACKSET

All models come with adjustable latch. Adjustable latch was preset at factory for a 2-3/8" (60mm) backset . If a 2-3/4" (70mm) backset is required, please adjust as shown below.

A. This latch is presently set for 2-3/8" (60mm) backset.

B. Push up spindle cam in direction of arrow ① then pull in direction of arrow ②
C. Your latch is now set for a 2-3/4" (70mm) backset.

D. To reset 2-3/8" (60mm) backset just reverse procedure B.

NOTE :

Be sure to keep spindle cam square in correct position as illustrated before pushing spindle cam to left. Otherwise you will have difficulty in pushing spindle cam to left.

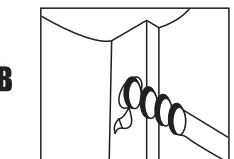
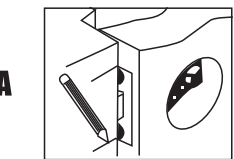

4. INSTALL STRIKE

A. Close door until latchbolt touches jamb to locate strike in jamb and center line of strike. Open door and extend line from mark to door stop. Measure half of door thickness from door stop and vertically mark drill point center for strike.

B. Drill 1" (25.4mm) hole 1/2" (13mm) deep in door jamb on drill point for strike.

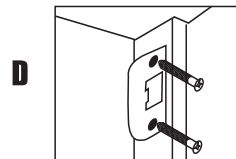
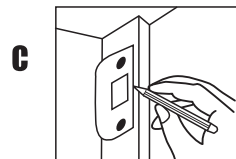

CAUTION:

To ensure proper lockset function, hole in jamb must be drilled a full 1/2" (13mm) deep.

C. Match screw holes on strike with center line on jamb Outline outside edge of strike. Chisel 1/16" (1.6mm) deep for strike

D. Adjustable tang on strike permits bending in or out to eliminate too loose fit between door and door stop.